

PROPRIETARY DATA

HE0400-C

B

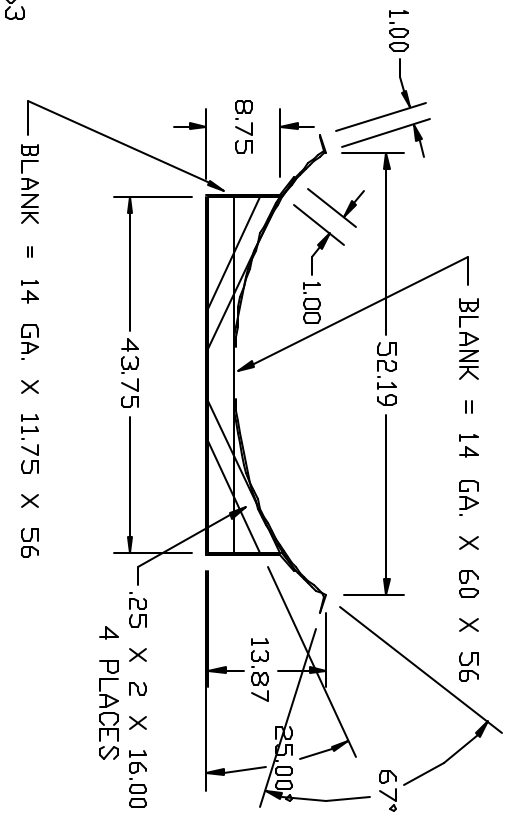
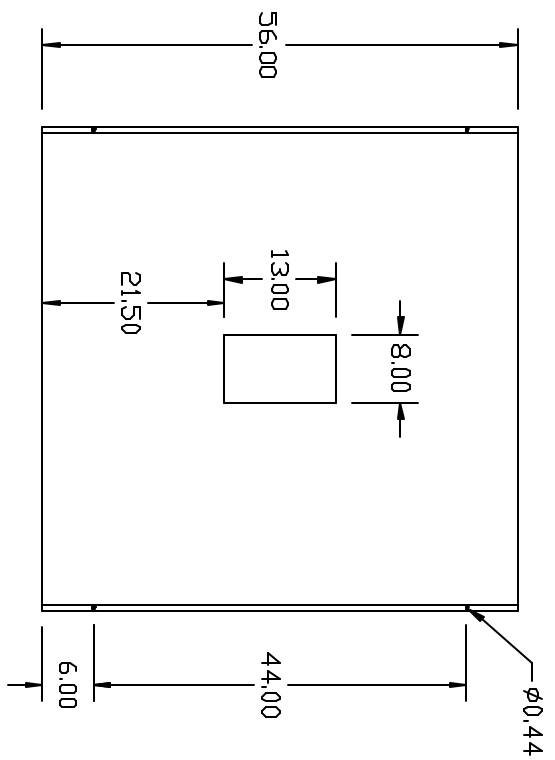
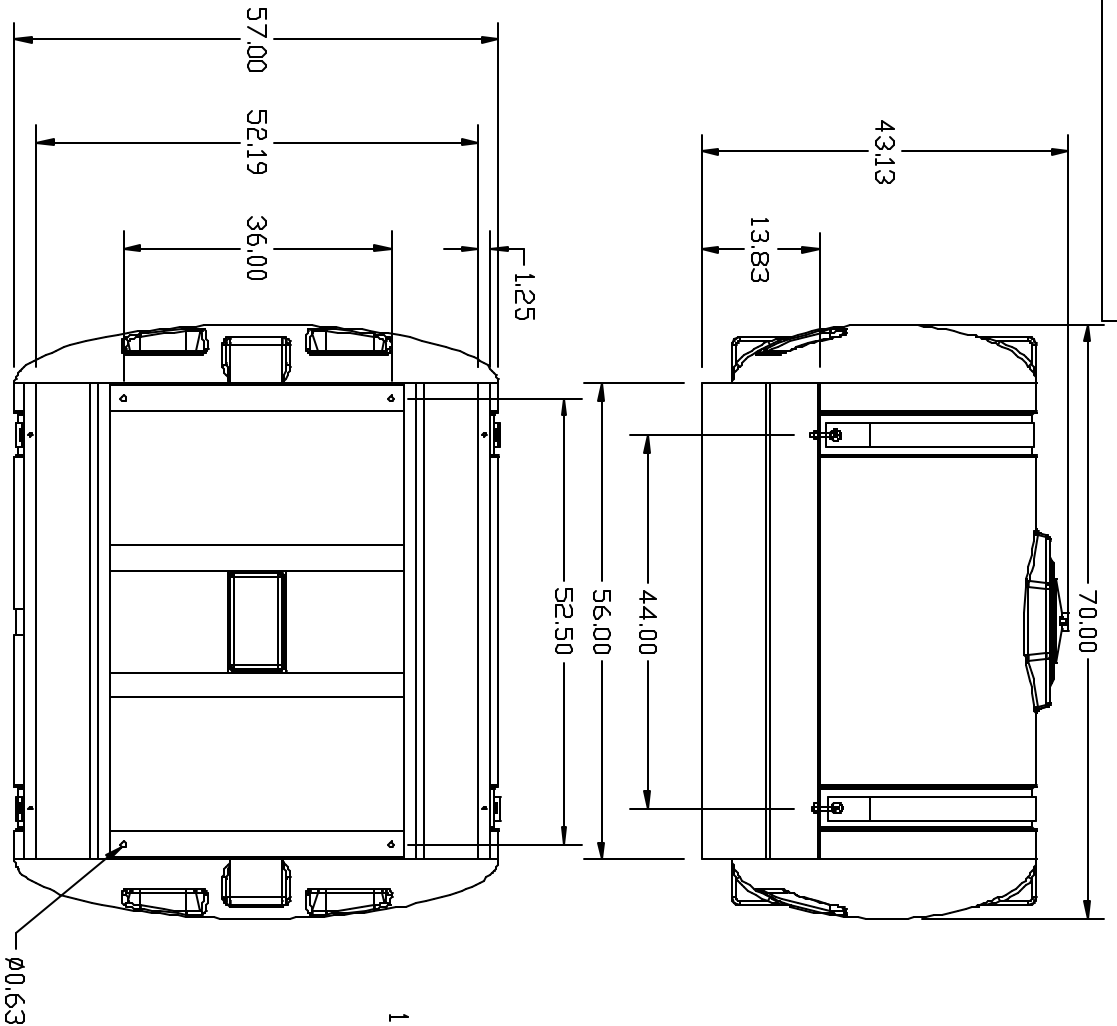

REV	DESCRIPTION	DATE	APPRD	DRAWN / DATE	MATERIAL / SHOT WEIGHT
A	CHANGE PART #	3/30/06		REH/10/04/01	M111 M134 U625 P938
A	CHANGE WIDTH OF BASE	4/15/04		APPRD. / DATE	
REV	DESCRIPTION	DATE	APPRD	REH/10/04/01	

**Ace Roto-Mold**  
 A DIVISION OF DEN HARTOG INDUSTRIES, INC.  
 4018 HWY. 80 BLVD., BOX 421, HOSPER, IOWA 51238

CLIENT / DESCRIPTION  
 ACE 400 GALLON ELLIPTICAL TANK  
 SKID ASSEMBLY AND PARTS LIST

ALL DIMENSIONS ARE IN DECIMAL INCHES  
 TOLERANCES UNLESS OTHERWISE SPECIFIED  
 + .5% @ 68° F

SCALE N.S.  
 PART NO. HE0400-C

